

SECUMAX 145 MDP

YOUR WORK HAS NEVER BEEN SO EASY.



THE SAFER WAY TO CUT.

**martor**

# SECUMAX 145 MDP

NO. 145007



Original size



#### 2 in 1 blade head

The blade head provides two functions: cutting and piercing. Use the knife's noses to the left and right of the blade to effortlessly pierce materials (e.g. card and film), and the blade head's corners for packing tape.



#### Concealed blade

With a 4 mm cutting access, the blade is highly concealed. Out of reach for fingers but accessible to the materials to be cut. And contents under the cutting surface will also be kept safe from contact with the cutting edge.



#### Stainless steel blade

Stainless steel blades are standard in the SECUMAX 145 MDP – optimal for regular use under demanding conditions and for cleaning with water.



#### Metal detectable

You are on the safe side when using the SECUMAX 145 MDP in areas requiring caution. The detectors are effective in the event that the disposable tool – or parts of it – unintentionally enter the production process.



#### Flat and robust design

It is not just the handle that has an extremely flat design – the cutting channel too measures just 1.5 mm. Less effort is required for cutting and the tool also retains its strength – thanks to a 0.5 mm blade and high-quality plastic.

## Compact design. Powerful performance.

### Metal detectable.

The SECUMAX 145 is our clever, compact safety knife for routine cutting tasks – also available in an MDP version. The metal-detectable plastic handle and 0.5 mm strong blade gives a robustness to the lightweight 14 g knife. Its concealed cutting edge easily copes with single-layered cardboard, film and packing tape and keeps your fingers safe. And because the SECUMAX 145 MDP is always traceable, your company is kept safe too.

## PRODUCT FEATURES

### Technical features



Maximum safety



Metal detectable



X-ray detectable



Disposable knife



Ergonomic



2-cutting edge blade



Cutting depth



For right and left handers



Lanyard hole



Stainless

### Main cutting materials



Cardboard: 1-ply



Wrapping, stretch, and shrink foil



Tape



Bagged goods



Layers of foil or paper



Yarn, cord

### Installed blade

» The stainless steel blade is moulded into the body of the knife and cannot be changed. Blade thickness 0,50 mm.

## Safety technology

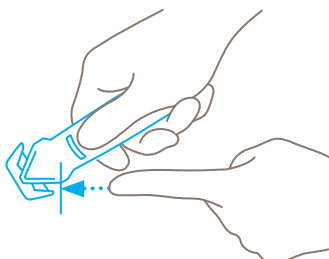

### Concealed blade – a maximum degree of safety

The SECUMAX 145 MDP blade is not an open one, but is hidden from people and goods. This provides you with a maximum degree of safety from cut injuries and from damage to goods.

## Certificates and awards





YOU CAN FEEL THE QUALITY.

#### SECUMAX 145 MDP

- › Concealed blade
- › Practical 2 in 1 blade head
- › Ergonomically shaped handle
- › Metal detectable plastic
- › GS-certified for approved safety

#### PRODUCT DETAILS

<b>Order No.</b>	NO. 145007.12
<b>Packaging unit</b>	10 in box (loose)
<b>Knife size (L x W x H)</b>	118 x 4 x 35.4 mm
<b>Main material</b>	Metal detectable plastic
<b>Weight</b>	13.7 g
<b>Cutting depth</b>	3.8 mm
<b>Certified</b>	GS certificate NO. 602578-6075-55094-2016 C
<b>Accessories</b>	
BELT HOLSTER S WITH CLIP	 NO. 9920
BUSINESS CARD TEST CARD SET	 NO. 9910

#### CONTACT AND SERVICE

What makes our cutting solutions even safer? Our advisory services! We are always on hand, to give advice, to provide you with training material, to meet with you in person if necessary.

You will find further information on our website: [www.martor.com](http://www.martor.com)



At a glance: the safety poster shows the most important functions and correct usage – perfect for your workplace.



From the first cut to changing the blade, our video will show you the best way to use this knife.



Everything you want to know: dimensions, properties, special features and more about our cutting tools can be found in the Technical Data Sheet.



Still have questions? You can reach our service department on [+49 212 73870-0](tel:+49212738700)