

SAFETY KNIFE SECUMAX 150

ORDER NOW!

Order No.	150001.12
Knife size (L x W x H)	148 x 11 x 37.2 mm
Weight knife	24.4 g
Basic material	Glass fibre reinforced plastic



MAXIMUM
SAFETY

Concealed blade
for maximum protection of
users and goods

**Innovative 3-in1
blade head**
for cutting, scraping
and splitting

Light ergonomic handle
for right and left handers

6 mm cutting depth
for all common cutting
materials



Guide surfaces
for easier diagonal cutting

Practical eyelet
for a secure attachment

**2-cutting edge blade
(not changeable)**
for a double period of use

THE SAFER WAY TO CUT.

martor

MARTOR SAFETY KNIFE SECUMAX 150

SAFETY TECHNOLOGY



SECUMAX
= maximum safety

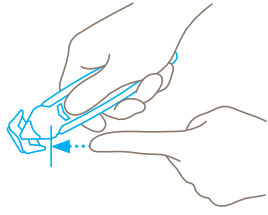

Concealed blade

The SECUMAX 150 blade is not an open one, but is hidden from people and goods. This provides you with a maximum degree of safety from cut injuries and from damage to goods.

TECHNICAL FEATURES



Disposable knife



Abrasion resistant



Very ergonomic



2-cutting edge blade



Cutting depth



Scraper width



Tape splitter



For right and left handers



Lanyard hole



Printable for promotional purposes

EXAMPLES OF USE



MAIN CUTTING MATERIALS



Cardboard: up to 2-ply



Wrapping, stretch and shrink foil



Tape



Plastic strapping band



Bagged goods



Layers of foil or paper



Yarn, cord



Felt

MOUNTABLE BLADES

The blade is moulded into the body of the knife and cannot be changed.
Blade thickness 0.30 mm.

PACKING INFORMATION

Packaging unit 10 in box (loose)

Size Single unit box 154 x 113 x 40 mm

Weight single unit box 295.0 g

EAN Code single unit box 4002632972133