

SAFETY KNIFE SECUNORM 525

ORDER NOW!

Order number	52500410.02
Knife size (L x W x H)	143 x 17 x 31 mm
Weight knife	81.0 g
Basic material	Aluminium
Variations	52501410.02 52500110.02



HIGH
SAFETY

Automatic blade retraction
for a high user protection

Robust ergonomic handle
for the toughest challenges

New blade change button
for the particularly simple and safe blade change (incl. magnet)

21 mm cutting depth
for all common cutting materials

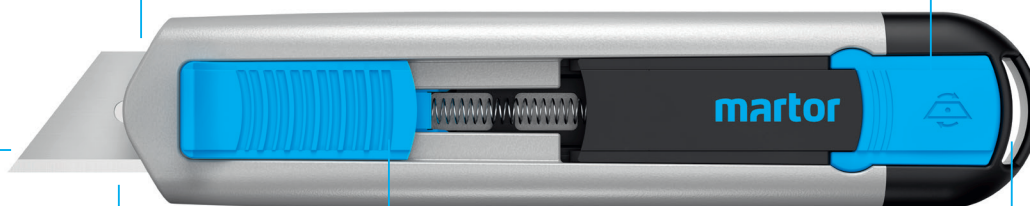

New large slider
for powerful work

2-cutting edge blade
for a longer period of use

Practical eyelet
for a secure attachment

THE SAFER WAY TO CUT.

martor

MARTOR SAFETY KNIFE SECUNORM 525

SAFETY TECHNOLOGY



SECUNORM
= high safety

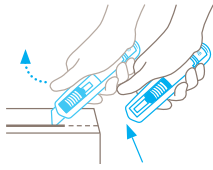

Automatic blade retraction

Thumbs up for a high degree of safety. As soon as you start cutting, remove your thumb from the slider and the blade will disappear into the handle the moment it loses contact with the material being cut.

TECHNICAL FEATURES



Safer blade change
(with magnet)



Very abrasion resistant



Very ergonomic



2-cutting edge blade



Cutting depth



Ceramic blade
insertable



For right and
left handers



Lanyard hole



Printable for
promotional purposes

EXAMPLES OF USE



MAIN CUTTING MATERIALS



Cardboard:
up to 3-ply



Wrapping, stretch and
shrink foil



Plastic strapping band



Slabbing material
off a roll



Foam, polystyrene



PVC



Bagged goods



Fleece

MOUNTABLE BLADES

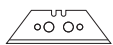

TRAPEZOID BLADE NO. 99
0.63 mm, deep-edged, 10 in dispenser

NO. 99.70



CERAMIC BLADE NO. 60099C
0.65 mm, ceramic, rounded blade tips,
deep-edged, 2 on self-service card

NO. 1760099.25



TRAPEZOID BLADE NO. 60099
0.63 mm, rounded blade tips, deep-edged,
10 in dispenser

NO. 60099.70

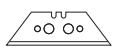

TRAPEZOID BLADE NO. 199
0.63 mm, deep-edged, stainless,
10 in dispenser

NO. 199.70

PACKAGING INFORMATION

Packaging unit (PU) 1 in single unit box
(10 in multipack)

Size PU 153 x 21 x 37 mm

Weight PU 94.0 g

EAN Code PU 4002632801785

Size Outer Box 114 x 78 x 156 mm

Weight Outer Box 980.0 g

EAN Outer Box 4002632851780

For further information please contact us: **MARTOR KG** | Lindgesfeld 28 | 42653 Solingen | Germany
T +49 212 73870-0 | F +49 212 73870-90 | info@martor.de | www.martor.com